

EN	DE	EN	DE	open Position	while Cleaning / Filling	Hub und Öffnungsquerschnitte	offene Position	während Reinigung / Befüllen
Product Information	Produktinformationen	Stroke and Passages						
according to DIN 6650, DIN 3542 and FDA regulations	Produkt nach DIN 6650, DIN 3542 und FDA-Bestimmungen	I CO ₂ valve + tube part 4 + part 1 - part 8	A	3mm	4-6 mm	CO ₂ -Dichtung + Steigrohr Pos. 4 + Pos. 1 - Pos. 8	A	3 mm 4-6 mm
gastight	gasdicht	beer valve part 5 - part 4	B	4 mm		Bierventil Pos. 5 - Pos. 4	B	4 mm
For specific length calculation keg drawing or H3-dimension is needed according to DIN 6647.	Für konkrete Längenberechnung wird die Keg-Zeichnung oder das H3-Maß nach DIN 6647 benötigt.	II inside the beer valve part 5	C	64 mm ²		innerhalb des Bierventils Pos. 5	C	64 mm ²
mounting torque: 80±5 Nm	Anzugsdrehmoment: 80±5 Nm	through inner tube part 5 - part 1	D	140 mm ²		innerhalb des Steigrohres Pos. 5 - Pos. 1	D	140 mm ²
temperature resistance short-time 135°C	Temperaturbeständigkeit kurzfristig 135°C	through inner tube Ø17,6 part 1	E	240 mm ²		innerhalb des Steigrohres Ø17,6 Pos. 1	E	240 mm ²
for more information www.dispensegroup.com	für mehr Informationen www.dispensegroup.com	III in part 8	F	1560 mm ²		in Pos. 8	F	1560 mm ²

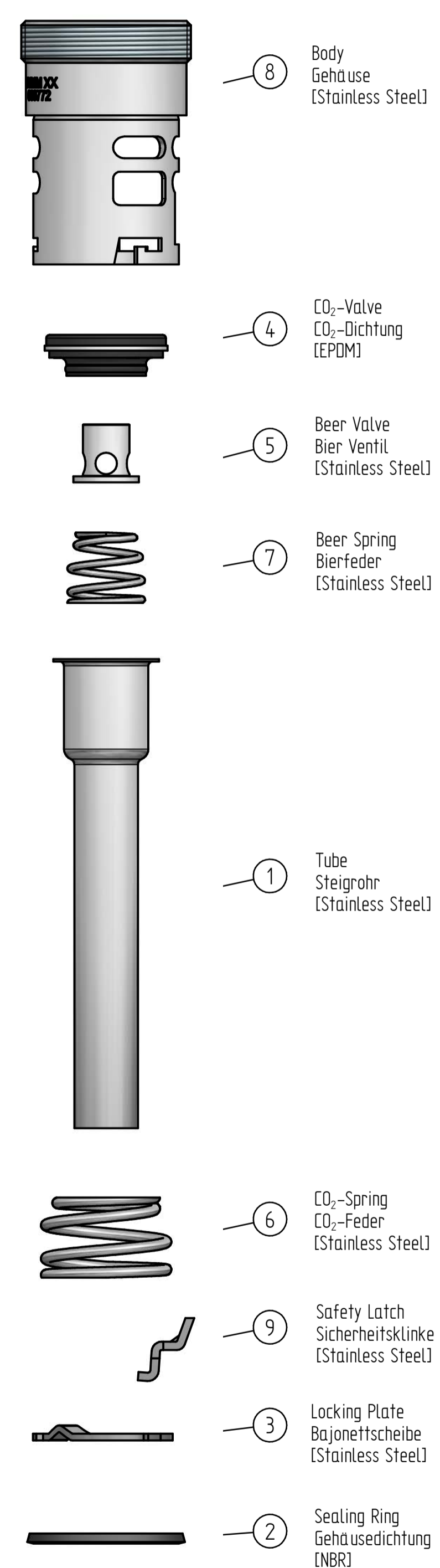
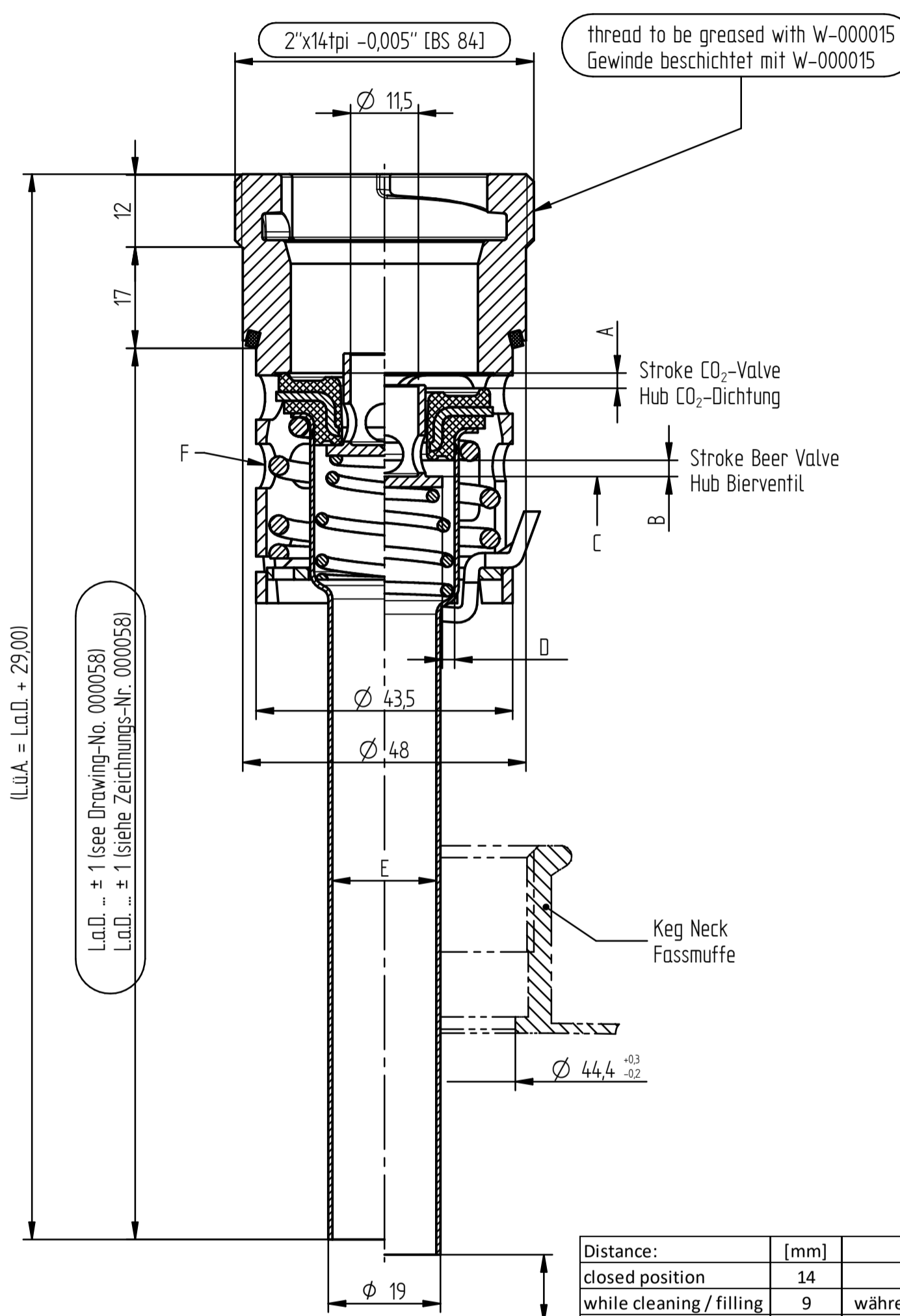

Pos.	Quantity	Art.-No.	Title
1	1	000055	Down Tube UEC
2	1	026363.7	Sealing Ring
3	1	026367.0	Locking Plate
4	1	027531.9	CO2 Valve
5	1	027532.1	Beer Valve
6	1	61076.9	Spring, CO2, UEC
7	1	61077.0	Spring, Beer, UEC
8	1	61077.2	Body U SI 2"x14tpi
9	1	61107.0	Safety Latch, flat

weight calculation ± 5% / Gewichts Berechnung ± 5%

$$m [g] = (L. a. D. [mm] - 45) * 0,315 \frac{g}{mm} + 370g$$

PRODUCT		TOLERANCES	LAST CHANGE	SCALE	WEIGHT
		DIN ISO 2768-mS	AM	1:2,1 (1:1,25)	VOLUME
		ROUGHNESS		MATERIAL	
		DIN EN ISO 1302			
		EDGES	- X Δ		
		DIN EN ISO 13715			
DESIGN	DATE	NAME	TITLE		
AM	29.04.2015	lasko	Extractor Tube U SI 2"x14tpi		
DESIGN	DATE	NAME			
AM	30.04.2015	3024			
DESIGN	DATE	NAME			
AM	22.04.2020	kunze			
DESIGN	DATE	NAME			
AM	22.04.2020	kunze			
FILE NAME: 000055_ET-U-SI_bstlgt.dwg			PROJ. METHOD	FORMAT	DRAWING NUMBER
DRAWING NAME: 000055_Masterdrawing ET U SI.dwg				A2	000056
DSI MICRO MATIC			SHEET		
A new logo DSI			1		
ALTERATIONS	DATE	NAME	AM	PROD. DEV.	GERMANY
	22.04.2020	Kunze	4427	REPL.	REPL. BY

This drawing is the property of Dispense Systems International. The information on it is confidential and must not be copied for any other purpose without the prior written permission of DSI Getränkeautomaten GmbH. If in doubt, please ask. Samples are required after each revision.