

EN	DE	EN	DE
Product Information	Produktinformationen	Stroke and Passages	Hub und Öffnungsquerschnitte
according to DIN 6650, DIN 3542 and FDA regulations	Produkt nach DIN 6650, DIN 3542 und FDA Bestimmungen	CO ₂ valve + tube part 3 - part 1	CO ₂ -Dichtung + Steigrohr Pos. 3 - Pos. 1
gastight	gasdicht	CO ₂ valve - ball in part 1	CO ₂ -Dichtung - Kugel in Pos. 1
for specific length calculation keg drawing or H3-dimension is needed according to DIN 6647	Für konkrete Längenberechnung wird die Keg-Zeichnung oder das H3-Maß nach DIN 6647 benötigt	inside the seal part 1	innerhalb der Dichtung Pos. 1
mounting torque: 35±5 Nm	Anzugsdrehmoment: 35±5 Nm	inside the seal part 1	innerhalb der Dichtung Pos. 1
temperature resistance short-time 135°C	Temperaturbeständigkeit kurzfristig 135°C	through inner tube Ø17,6 part 1	innerhalb des Steigrohres Ø17,6 Pos. 1
for more information www.dispensegroup.com	für mehr Informationen www.dispensegroup.com	through outer tube part 3 - part 1	außerhalb der Dichtung Pos. 3 - Pos. 1
		in part 4	In Pos. 4

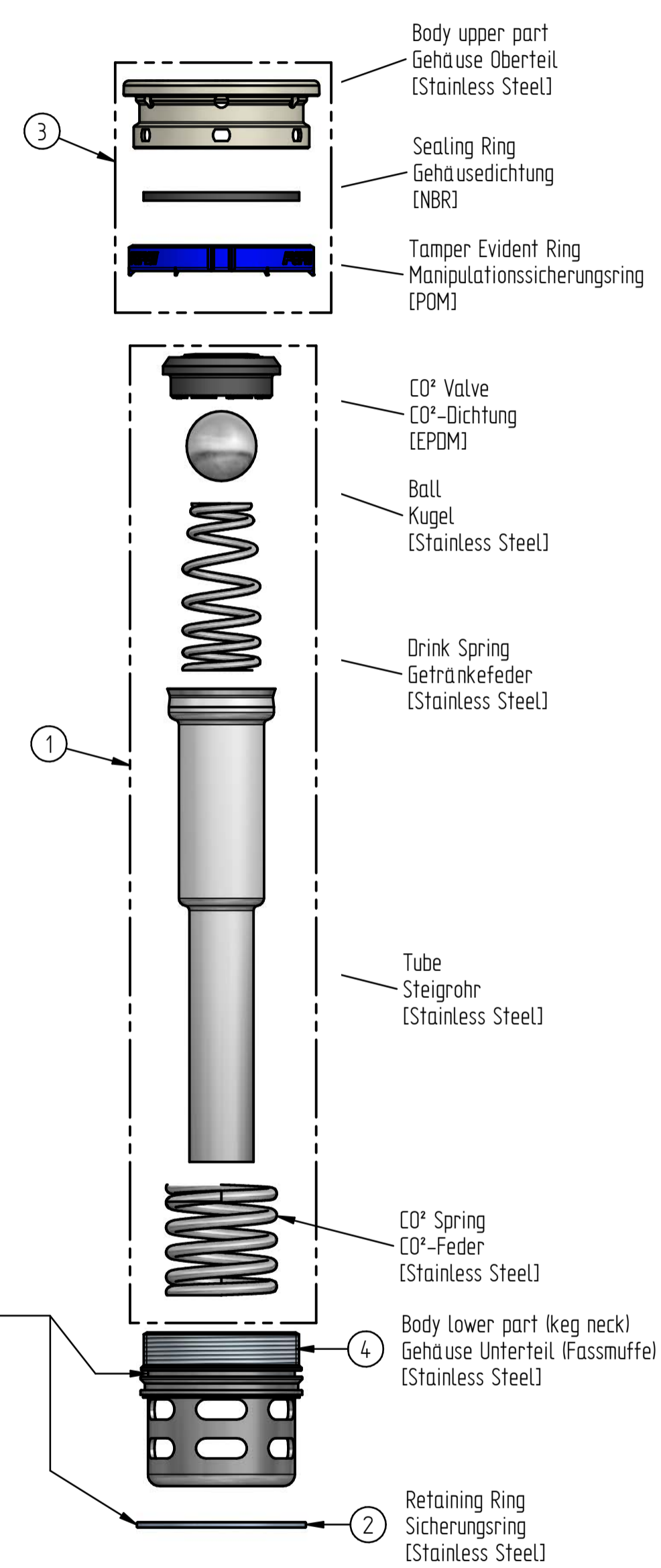
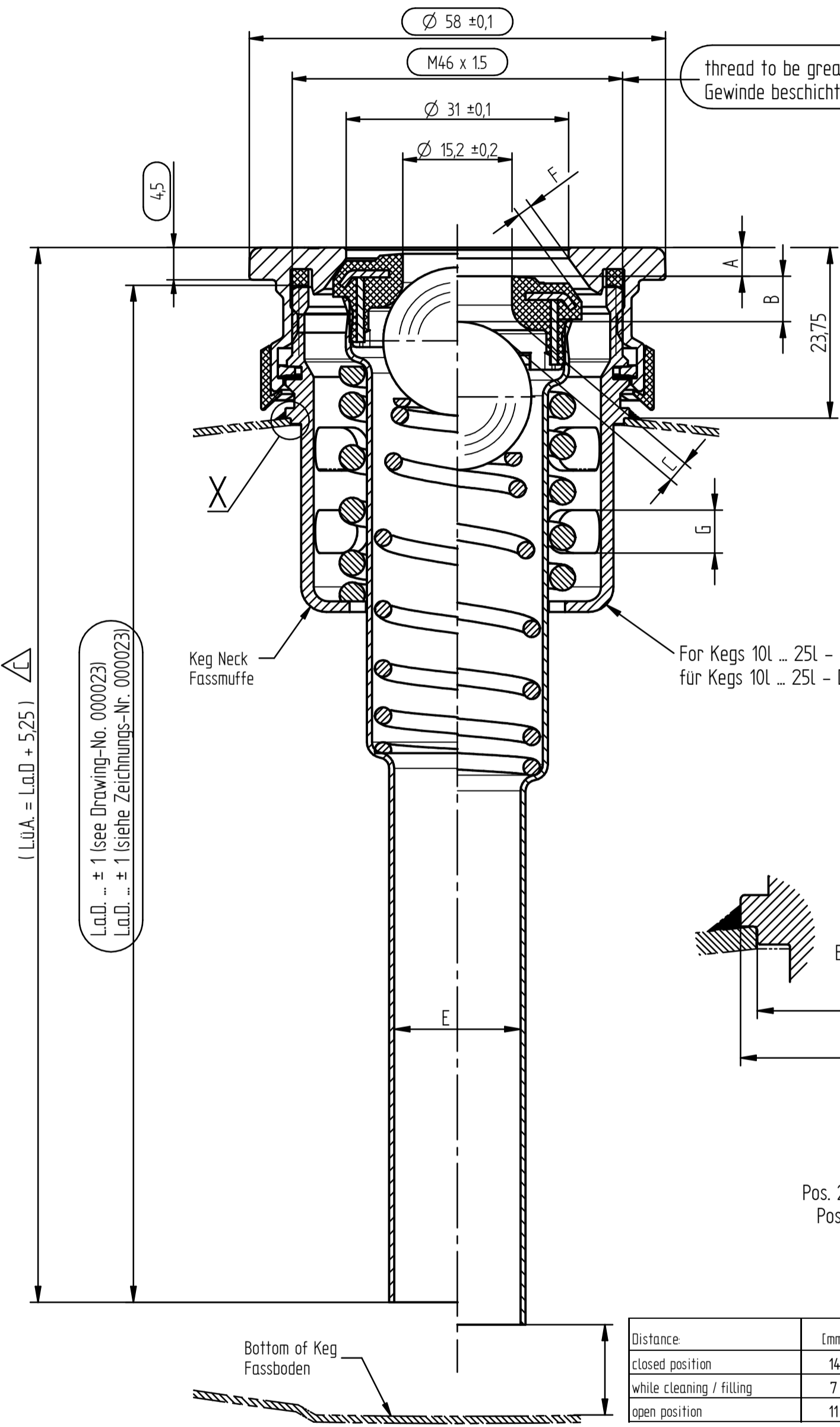

Distance	[mm]	Abstand
closed position	14	geschlossene Position
while cleaning / filling	7	während Reinigung / Befüllen
open position	11	geöffnete Position

weight calculation ± 5% / Gewichtsrechnung ± 5%

$$m [g] = (L. \ddot{u}. A. [mm] - 80mm) * 0,315 \frac{g}{mm} + 320g$$

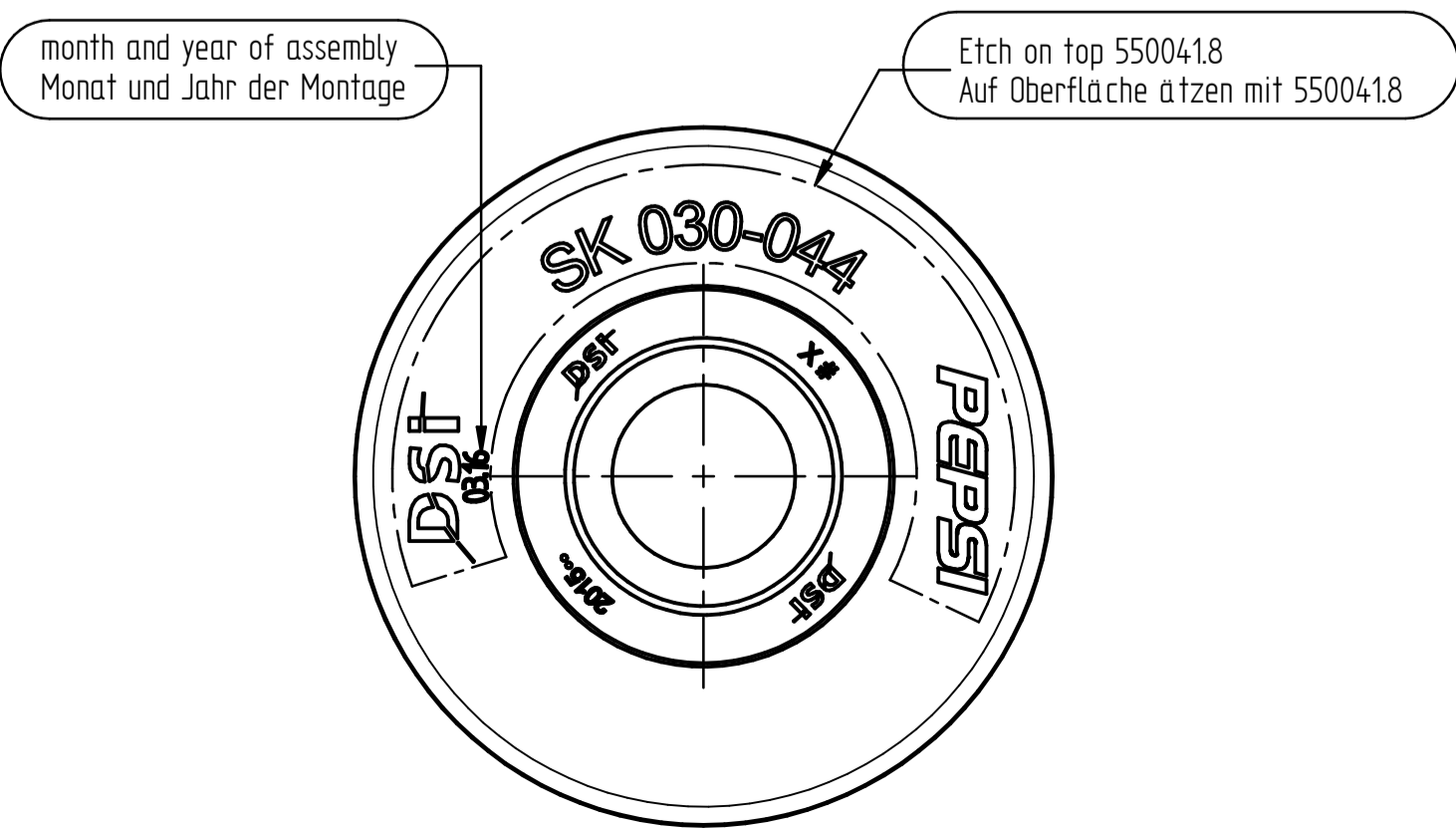

Pos.	Quantity	Art.-No.	Title
1	1	000074	Master Down Tube Assembly SD
2	1	550029.7	Retaining Ring
3	1	550067.1	SD-ET-PC upper part
4	1	611206	Keg Neck SD

PRODUCT	REMARKS	LAST CHANGE	SCALE 2 : 1 (1 : 1)	WEIGHT VOLUME		
For Kegs 10l ... 25l - DIN 6647-2 für Kegs 10l ... 25l - DIN 6647-2	DIN ISO 2768-mH ROUGHNESS DIN EN ISO 1302 EDGES DIN EN ISO 13715	3 x Δ				
DESIGN	DATE	NAME	TITLE			
AM 31.08.2015		Wilhelm	Master Extractor Tube SD-PC			
AM 04.07.2016		lasko				
SD 10.05.2016		kunze				
FILE NAME: 000074_Masterdrawing_SD-ET-PC_unbedruckt.dwg						
PROJECT	DATE	NAME	PROJECT METHOD	FORMAT	DRAWING NUMBER	SHEET
DSI	24.06.2016	lasko	3516	A2	000076	1
B 611206 was 550044.0	10.05.2016	kunze	3459			1
A 550067.1 replaces components	31.03.2016	lasko	3420			1
ALTERATIONS	DATE	NAME	AM	PROD. DEV.	GERMANY	REPL. BY

This drawing is the property of Dispense Systems International. The information is confidential and should not be copied for any other purpose without the prior written permission of DSI Getränkeautomaten GmbH. If in doubt, please ask. Samples are required after each revision.